

USB A-TYPE PLUG CONNECTOR

SCU103D SERIES

Dimension (m/m)

Housing

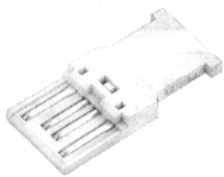

HOUSING

P/N	Color
J103A1B10AD	Black
J103A1I10AD	Ivory
J103A1W10AD	White

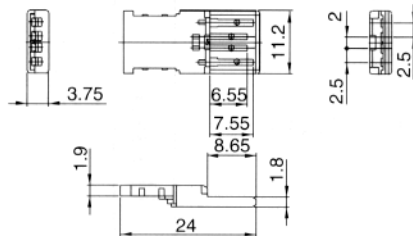

Cover



COVER

P/N	Color
J103A2B10AD	Black
J103A2I10AD	Ivory
J103A2W10AD	White

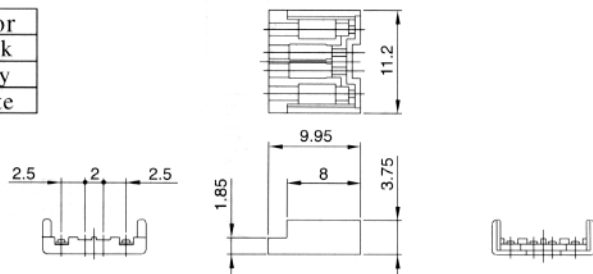

Front Shell

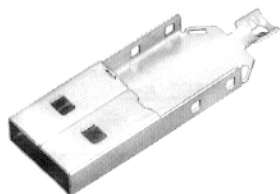

FRONT SHELL

P/N	Plating
J103CGT10A0	Light Tin Over Cu
J103CGN10A0	Light Nickel Over Cu

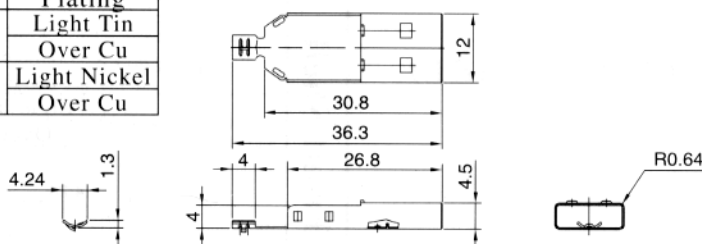

Rear Shell

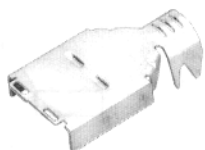

REAR SHELL

P/N	Cable O. D.	Dim. A	Dim. B
J103CGT1AA1	Ø 3.2 ~ Ø 4.0mm	6.0mm	6.8mm
J103CGT1BA1	Ø 4.0 ~ Ø 5.0mm	7.0mm	9.0mm

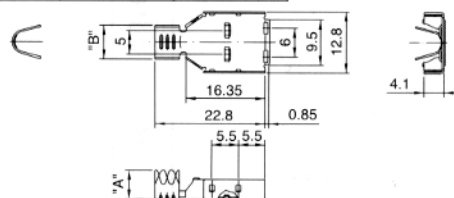

SCU 103D

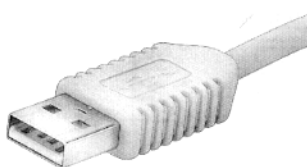

Feature

SCU103D series is USB, A-type, plug connector for cable ass'y with solder terminal type.

It can supply together with metal cover and solder terminated insulator.

Construction

- Housing : PBT & glass fiber, UL94-V0
- Contact : Brass
- Shell : SPCC
- Color : Black, Ivory, White

Specification

- Voltage rating : 1AMP, 30VAC
- Insulation resistance : 1000MΩ min
- Contact resistance : 30MΩ max
- Dielectric withstanding voltage : AC 750V
- Temperature rating : -55°C to + 105°C

Ordering Information

SCU103

- Series No.
SCU103 = USB A-type, plug connector
- Terminal option
D : Solder terminal type
- Contact plating ("G" is standard)
G : Selective gold flash over 30"u
Pd-Ni over 50"u nickel
J : 30"u selective gold over 50"u nickel
- Front shell plating option
0 : Light tin over cu
1 : Nickel over cu
- Rear shell S/R dia. option
0 : For cable O. D. Ø 3.2 ~ Ø 4.0mm
1 : For cable O. D. Ø 4.0 ~ Ø 5.0mm
- Insulator color option
B : Black I : Ivory W : White
- Special option
0000 : No special option